

Movax Piling Rig Doosan DX340LC + SPH-80

Excavator	Doosan DX340LC
Engine Type	Doosan DL008
Rated Power	184 kW @ 1750 rpm
Maximum Torque	736 Nm @ 1300 rpm
Monoboom Length	6.50 m
Arm Length	3.20 m
Ground Bearing Pressure	190 kN/m ²
Transport weight ^a	34.1 tonnes
Operating Weight (approx.) ^b	35 - 38 tonnes

^a Transport weight = excavator + counterweight & boom (excludes attachment)

^b Operating weight = excavator + counterweight & boom + attachment

Dimensions	(mm)
(A) Overall width of upper structure	2990
(B) Overall width of cabin	1010
(C) Overall height of cabin	3125
(D) Tail swing radius	3500
(E) Overall height	3360
(F) Clearance under counterweight	1195
(G) Ground clearance	510
(H) Tumbler distance	4050
(I) Track length	4940
(J) Track gauge (standard)	2680
(K) Track shoe width	800
(L) Overall length	11280
(M) Overall width (standard track)	3400

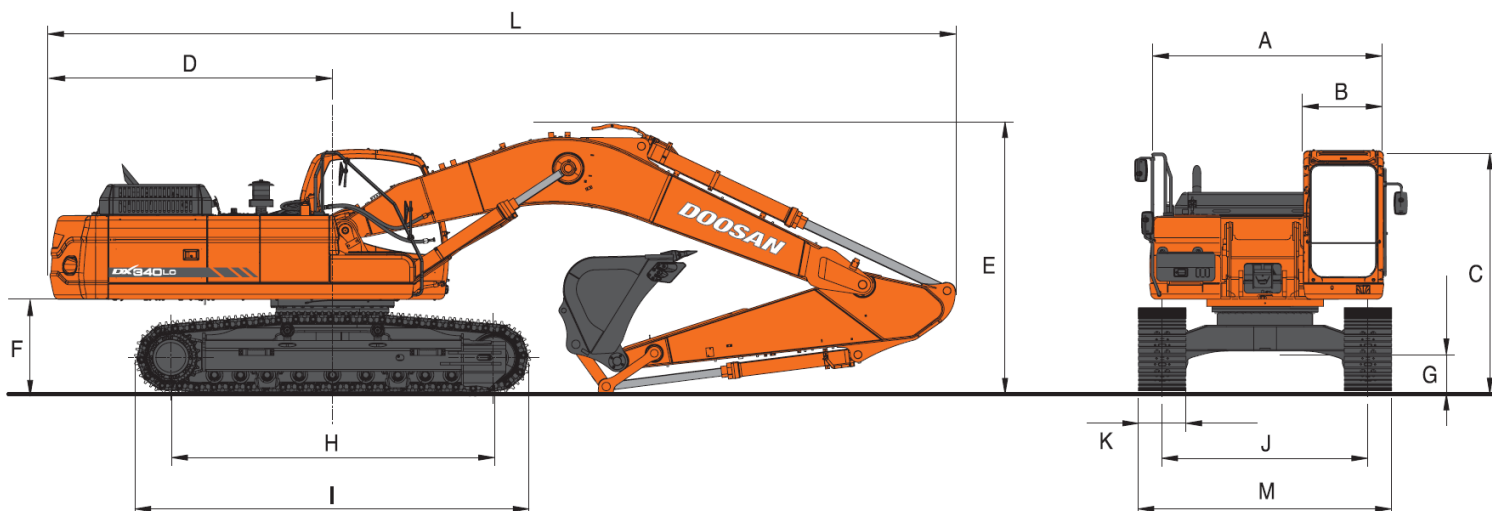

Working Ranges

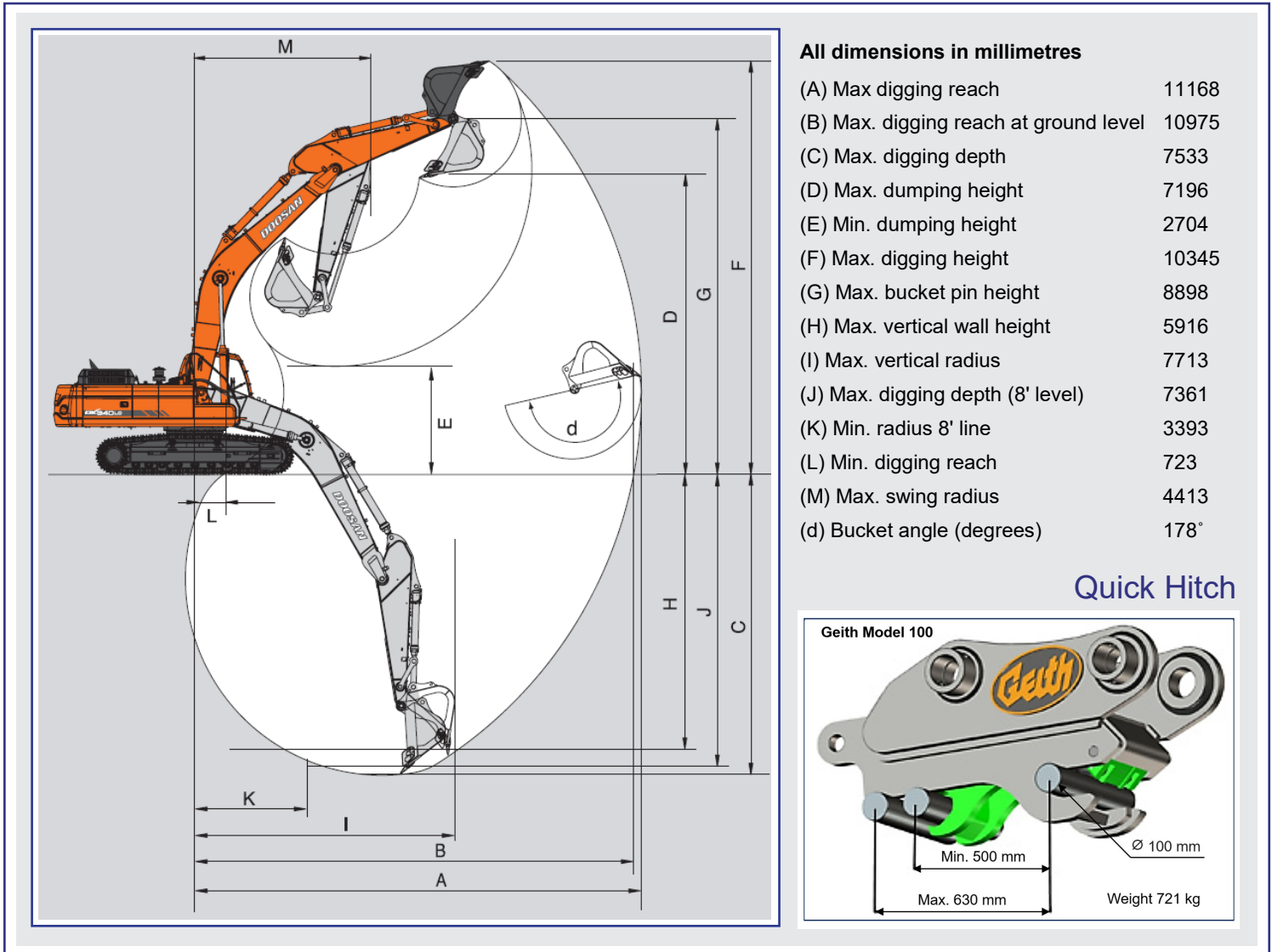

Lifting Capacities

- Notes:
1. The nominal forces are based on the SAE J1097 Standard.
 2. The load point is the hook at the rear of the bucket.
 3. * Nominal loads are based on hydraulic capacity
 4. The nominal loads do not exceed 87% of the hydraulic capacity or 75% of the capacity of the swing.
 5. 0 m = Ground

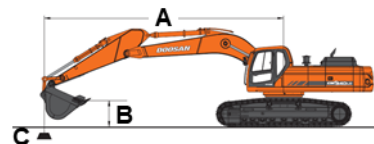

A: Load radius
B: Load point height
C: Lifting capacity

For lifting capacities, subtract quick-hitch, Movax attachment and any accessory weight from lifting capacities.



Rating over front



Rating side or 360 degrees

Unit : kg

Conditions	Load point height (m)	Load radius														Max. lift						
		2.0 m		3.0 m		4.0 m		5.0 m		6.0 m		7.0 m		8.0 m		9.0 m		metre				
		Rating over front	Rating side or 360 degrees	Rating over front	Rating side or 360 degrees	Rating over front	Rating side or 360 degrees	Rating over front	Rating side or 360 degrees	Rating over front	Rating side or 360 degrees	Rating over front	Rating side or 360 degrees	Rating over front	Rating side or 360 degrees							
Boom 6.5 m Arm 3.2 m Shoe 600 mm	8.0																		*6290	*6290	7.48	
	7.0																			*6300	*5680	8.19
	6.0																			*6360	5000	8.73
	5.0																			*6460	4540	9.12
	4.0																					
	3.0																					
	2.0																					
	1.0																					
	0																					
	-1.0	*8480	*8480	*11680	*11680	*18830	14390	*15270	10360	*12360	7820	9860	6180	7990	5040	6850	4190	5560	4130	5560	4130	9.08
	-2.0	*11830	*11830	*15140	*15140	*18900	14900	*15040	10320	*12300	7770	9810	6140	7960	5010			7030	4430	7030	4430	8.66
	-3.0	*15340	*15340	*19150	*19150	*17850	15000	*14400	10360	*11860	7780	9820	6150	7990	5040			7810	4920	7810	4920	8.12
-4.0	*18260	*18260	*20480	*20480	*16280	15180	*13270	10460	*10970	7860	9060	6230					*8360	5750	*8360	5750	7.39	
-5.0	*22580	*22580	*17360	*17360	*14030	14030	*11510	10660	*9400	8020							*8560	7250	*8560	7250	6.42	
-6.0					*10700	*10700	*8630	*8630									*8490	*8490	*8490	*8490	5.07	

Attachments

Movax SPH-80

Weight (excl. adapter)	2896 kg
Width	1130 mm
Height	2284 mm
Depth	1259 mm
Centrifugal force. Max.	700 kN
Frequency	2 speed vibration
Pressure Setting	320 Bar
Return pressure. Max	5 Bar
Swing angle	+/- 360°
Tilt angle	+/- 30°
Clearance to centre line of pile	800 mm

Suitable Pile Types & Dimensions

Sheet pile (width)	600 - 1200 mm
Sheet pile (depth)	230 mm
H-beam minimum size	H240
Tubular piles (sizes) [tubular pile clamps fitted to sheet piler's clamps required]	Ø220, Ø200, Ø190, Ø170, Ø140, Ø115, Ø90 [individual for each pilot type]



Length & Weight of pile	< 8 m / 1400 kg
	> 8 m / 2200 kg



Accessories

ABI Dangle Drill	BA2200
Height (H1)	1390 mm
Height (H2)	1205 mm
Width (B)	710 mm
Depth (T)	540 mm
Transport Weight	700 kg
Torque	2200 daNm
Revolutions (max.)	50 per min ⁻¹
Static extraction force (max.)	200 kN
Hydraulic flow rate	220 l/min
Hydraulic power at auger drive (max.)	60 kW
Nominal oil pressure	32 MPa
Hexagon connection (SW - Z socket/male)	80 mm

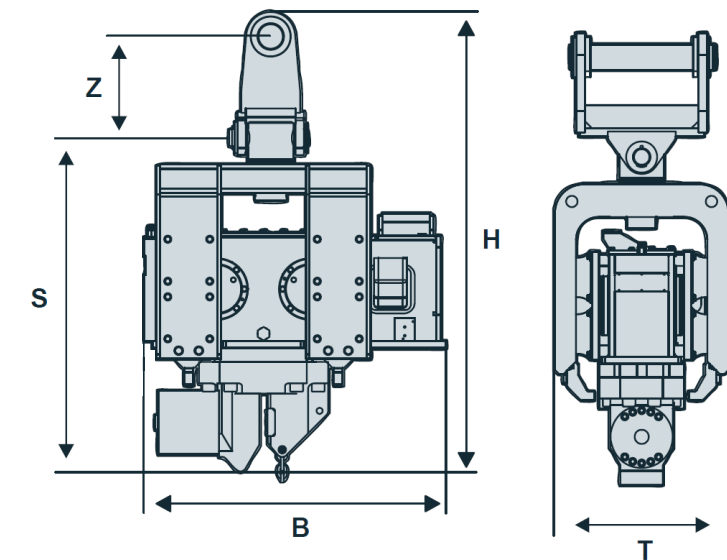
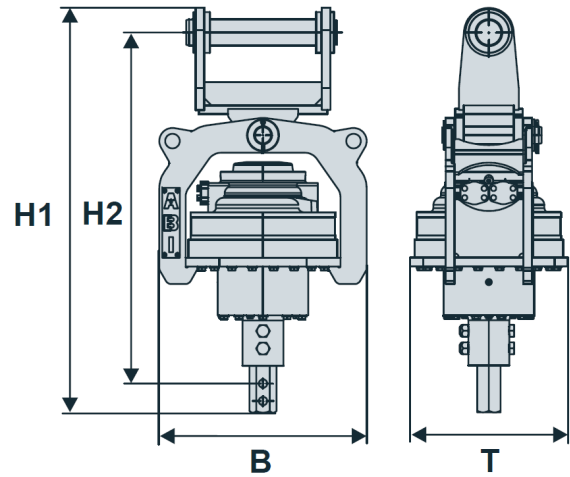

ABI Vibrator	HVR45
Height (H)	1600 mm
Width (B)	1065 mm
Depth (T)	615 mm
S	1160 mm
Z	352 mm
Static moment	4.5 kgm
Dynamic mass	815 kg
Nominal revolutions	2460 per min ⁻¹
Centrifugal force at nominal frequency	300 kN
Static extraction force (max.)	40 kN
Nominal oil pressure	32 MPa
Hydraulic flow rate	130 l/min
Hydraulic power at pmax ^a	70 kW
Total weight	1160 kg
Transport weight	1240 kg

^a pmax = actual pump pressure at maximum power

BSP Air Hammer	600N	700N
Weight of ram	227 kg	385 kg
Stroke of ram	305 mm	330 mm
Energy per blow (max.)	415 kg/m	281 kg/m
Blows per minute (max.)	250	225
Recommended compressor	10.3 m ³ /min	17 m ³ /min
Weight of basic hammer with legs	2177 kg	3006 kg
(A) Overall height (Z section pairs, U section singles)	2273 mm	2419 mm
(A) Overall height (Z section singles, U section pairs)	2184 mm	2261 mm
(B) Depth of cylinder	508 mm	610 mm
(C) Anvil to base guide leg	900 mm	900 mm

